

Sun Deck

This is the top-most deck of the yacht where you will find plenty of reclinable lounge chairs for sunbathing while on your Galapagos cruise or for reading in the open air.

Albert Deck

On this deck you will find 2 Master Suites and 2 Twin Suites with ocean-view windows. The captain's bridge, the al-fresco lounge and al-fresco bar are also located on this deck.

Carolina Deck

On this deck you will find 4 Premium Staterooms (doubles and twins) with ocean-view port-holes.

Monaco Deck

This is the main deck of the yacht where you will find the interior dining room, reception area, boutique, main lounge and the Grace Kelly Suite. On the outside of this deck you will also find the al-fresco dining area, stern resting area and the jacuzzi.

Sun S-Deck

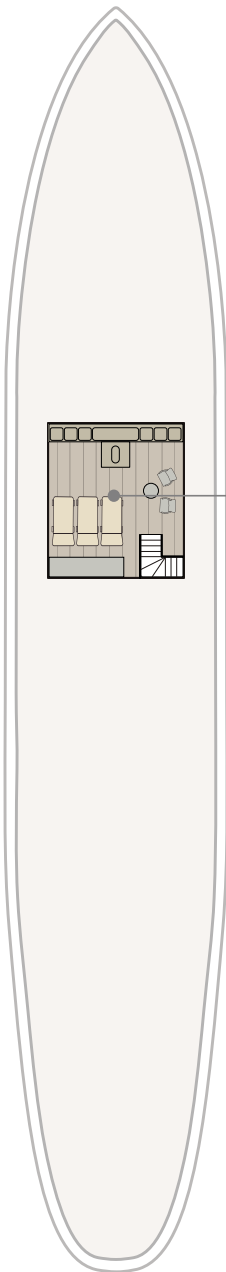

Albert A-Deck

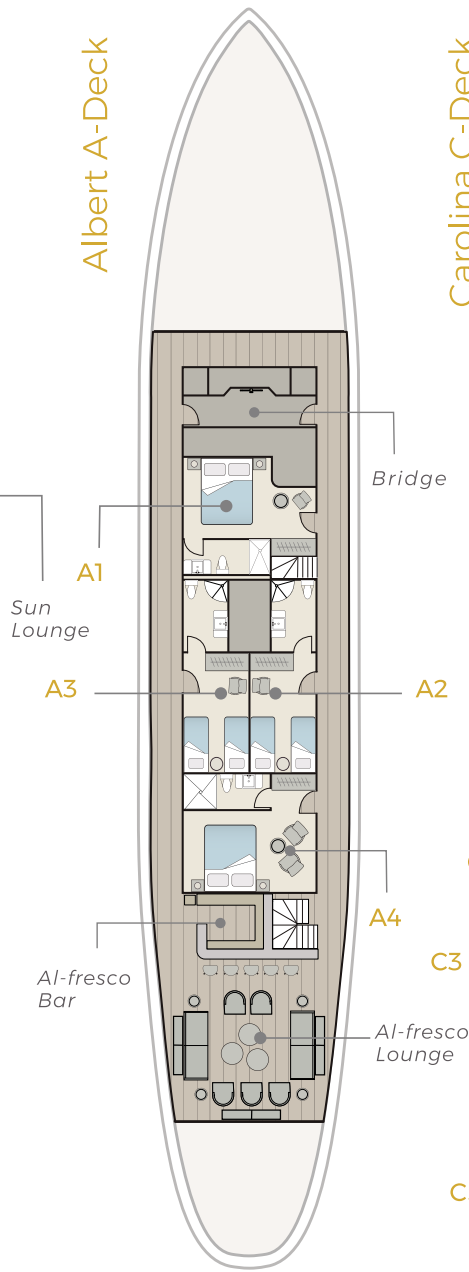

Carolina C-Deck



Monaco M-Deck

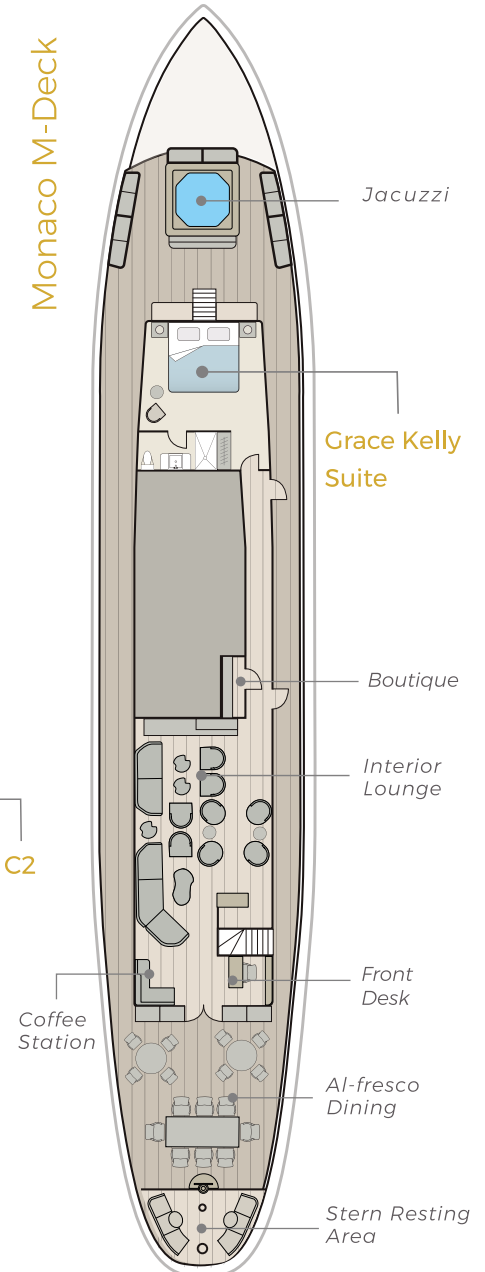

TECHNICAL INFO

Type	Motor Yacht / Expedition Vessel
LOA	145 feet / 44 meters
BEAM	22.1 feet / 7 meters
Engines	8 cylinder - Twin Deutz -500 bhp ea.
Generators	2 Caterpillar 75KW ea.
Builder	Camper & Nicholsons: South Hampton, England
Cruising Speed	12 knots
Accommodations	1 Master Suite on Monaco Deck 2 Master Suites on Albert Deck 2 Twin Suites on Albert Deck 2 Double Premium Staterooms on Carolina Deck 2 Twin Premium Staterooms on Carolina Deck
Crew	9 crew members plus 2 naturalist guides & 1 cruise director.
Navigation Equipment	72 mile Furuno Radar 19-53 CBB Navnet, Furuno GPS satellite navigator system, Furuno Depth Sounder, Simrad HS50 Electronic Girocompass, speed and distance log, compasses, barometers, forward looking echo sounder.
Onboard Safety Equipment	EPIRB (Emergency Position Indicating Radio Beacon), 2 x 16 person open sea life rafts, life jackets, flares and signals, fire extinguishing system, and sprinkler system throughout the vessel. Safety Onboard equipment on board either meets or exceeds USA Coast Guard regulations
Comfort Equipment	Air Renewal System, Air conditioning throughout, TV / CD / VHS/DVD , boutique, Jacuzzi
Communications Equipment	UHF, VHF radio, Satellite Phones
Electricity	110 volts AC / 60 Hz: 2 flat prongs